

# Landscape Application The Ridge

Date Received: \_\_\_\_\_ Application # \_\_\_\_\_ Approval Expires: \_\_\_\_\_

**APPLICATION MUST BE RECEIVED BY FRIDAY NOON THE WEEK BEFORE THE ACC MEETING FOR CONSIDERATION**

Lot Address: \_\_\_\_\_ Owner Name: \_\_\_\_\_

Owner Phone: \_\_\_\_\_ Owner Email: \_\_\_\_\_

Owner Mailing Address: \_\_\_\_\_

Contractor Name(s): \_\_\_\_\_

**Check each box verifying your acceptance of these standards:**

- PLANTING WITHOUT PRIOR APPROVAL MAY REQUIRE REMOVAL and/or REPLACEMENT
- PLANTS SUBMITTED THAT ARE NOT ON THE SUGGESTED PLANT LIST MUST BE SUBMITTED FOR REVIEW WITH LATIN GENUS AND SPECIES. NON-SUGGESTED PLANTS MAY BE REQUIRED TO BE REMOVED WHEN THE HOME OWNERSHIP IS CHANGED.
- SUBMIT CHANGES or ADDITIONAL PLANT VARIETIES FOR APPROVAL.
- PLANTS MUST NOT TOUCH NEIGHBOR'S SIDE WALL @ MATURITY
- TREE TRUNKS MUST BE 8 FT CLEAR ALONG NEIGHBOR'S SIDE WALL
- ASSESS FUTURE GROWTH: FRONDS/LIMBS MUST NEVER TOUCH or HANG OVER NEIGHBOR'S PROPERTY
- A 3 FT SOD BORDER MUST REMAIN BETWEEN DRIVEWAY & WALKWAY EDGE TO NEW BED EDGE
- ALL STONE PLANT BEDS MUST HAVE HARD EDGE BORDER
- HOMEOWNER HAS SOLE FINANCIAL RESPONSIBILITY FOR INSTALLATION & ANY DAMAGES INCURRED DURING PROCESS
- ALL ACTIONS RELATIVE TO OAK TREES MUST HAVE PRIOR APPROVAL BY ACC
- Review diagrams L-1 for further information & L-2 for application form to be included with submission
- The owner understands that neither the Architectural Control Committee nor the Board of Directors certifies compliance with any building, zoning, health, safety, or similar codes or standards. Approval(s) must be separately obtained, if applicable, from all necessary agencies by the owner.
- The owner hereby acknowledges that the governing documents, including but not limited to the Declaration of Covenants and Architectural Standards and Rules for the Ridge at the Bluffs, as amended from time to time, permit any agent of member of the Architectural Control Committee and/or Board of Directors access to the lot and/or improvement for the purpose of inspecting the work in progress and up to completion.

Home Owner's Signature: \_\_\_\_\_

\*\*\*\*\*

ACC Decision:  Approved     Approved with Conditions     Disapproved

Date of ACC decision: \_\_\_\_\_ Verified by: \_\_\_\_\_

ACC Conditions: \_\_\_\_\_

Recommendations: \_\_\_\_\_

\*\*\*\*\*

Completion inspected on \_\_\_\_\_ by \_\_\_\_\_ and \_\_\_\_\_  Approved  Not Approved

Comments: \_\_\_\_\_

# DIAGRAM L-1 Address

Application #

HOME OWNER'S UNLISTED PLANT REQUEST

LANDSCAPE COMMITTEE SUGGESTIONS

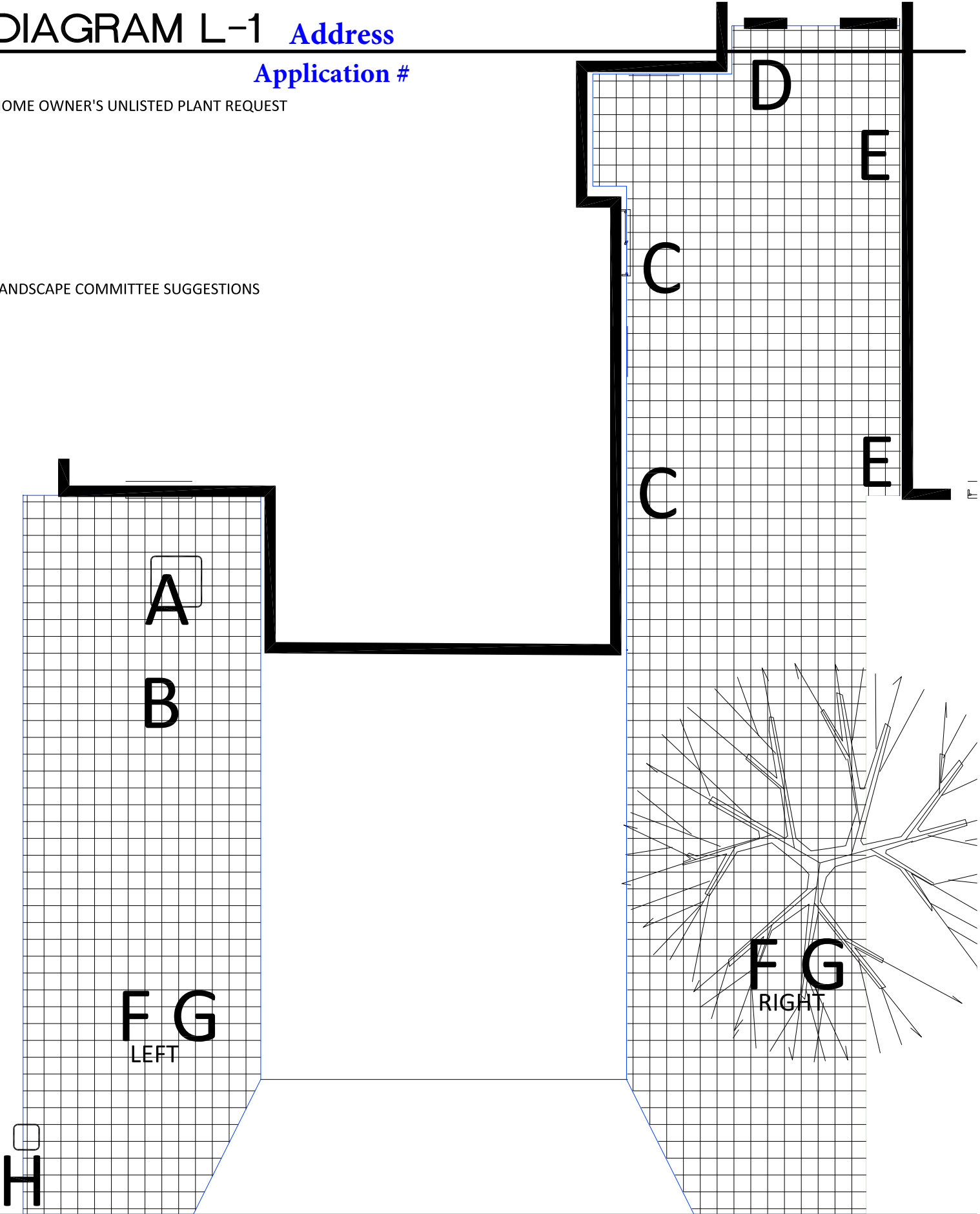

APPLICATION # \_\_\_\_\_

NAME \_\_\_\_\_

ADDRESS \_\_\_\_\_



# EXAMPLE DIAGRAM L-2

## FRONT YARD SUGGESTED PLANTS & PLANTING AREAS

### NOTE WELL:

PLANTINGS NOT INCLUDED IN THE SUGGESTED LIST MUST BE HIGHLIGHTED ON THE APPLICATION AND MAY NOT BE APPROVED. ALL TREES TRUNKS MUST BE 8 FT. FROM NEIGHBOR'S WALL OR HOUSE.

### SUGGESTED PLANTS & LOCATIONS

- S~ SHRUB
- SP~ SMALL PLANT
- F~ FLOWER
- LP~ LARGE PLANT
- T~ TREE

- S~LIGUSTRUM SHRUB - A, E
- S~ARBORICOLA (GREEN, GOLD) - A,C,D,E,H
- S~TRINETTE - B,C,E,H
- S~CLUSIA - A,E
- S~PODOCARPUS - A,C,E
- S~COPPER LEAF - A,E
- S~CROTON - B,C,D
- S~JASMINE - B,C
- S~COCO PLUM - A,B,C,E
- S~ALLAMANDA (STANDARD) - D
- S~VIBURNUM - A,E
- SP~LIRIOPE - B,C,G
- SP~GREEN ISLAND FICUS - B,C,D,E,G
- SP~CARISSA MACROCARPA - B,C,D,G
- SP~FOXTAIL FERN - G
- SP~BROMELIADS - G
- SP~IRIS - C
- F~VINCAS - G
- F~PENTAS - G
- F~LANTANA - G
- F~IMPATIENTS - G
- LP~ORANGE BIRD OF PARADISE - B,F
- LP~AGAVE/FALSE AGAVE - B,F
- LP~RUELLIA - B,G,H
- LP~FAKAHATCHEE GRASS - B,G,H
- LP~GINGER - B,C,E,F
- LP~CAT PALM - B,C,D,E
- LP~CRINUM LILY/QUEEN EMMA - B, F
- T~JATROPHA (STANDARD) - B,F
- T~ROBELLINI PALM - B,F
- T~FOX TAIL PALM (W/O OAK TREE) - F
- T~CHRISTMAS PALM (W/O OAK TREE) - F
- T~BISMARK PALM (W/O OAK TREE) - F

- AREA "A" - AREA AT AC UNIT
- AREA "B" - LOWER TIER PART OF "A"
- AREA "C" - ENTRY AGAINST HOME/GARAGE
- AREA "D" - RIGHT OF ENTRY DOOR
- AREA "E" - PLANTING EASEMENT
- AREA "F" - TREE LOCATION (RIGHT OR LEFT)
- AREA "G" - UNDER TREE (RIGHT OR LEFT) 14" MAX HGT.)
- AREA "H" - AREA AT CABLE/ELEC BOX

## Example Diagram

